

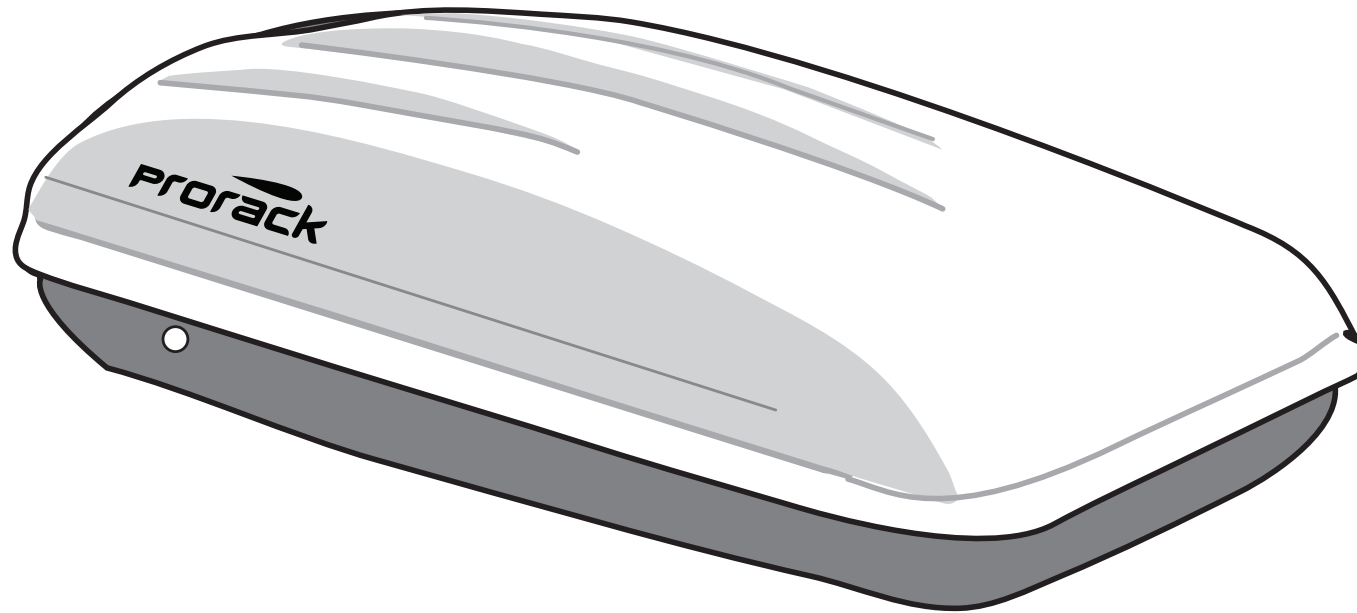

# EXPLORO 4 ROOF BOX



NO PRE-ASSEMBLY REQUIRED

## IMPORTANT WARNING!

IT IS CRITICAL THAT ALL PRORACK RACKS AND ACCESSORIES BE PROPERLY AND SECURELY ATTACHED TO YOUR VEHICLE. IMPROPER ATTACHMENT COULD RESULT IN AN AUTOMOBILE ACCIDENT, AND COULD CAUSE SERIOUS BODILY INJURY OR DEATH TO YOU OR TO OTHERS. YOU ARE RESPONSIBLE FOR SECURING THE RACKS AND ACCESSORIES TO YOUR CAR, CHECKING THE ATTACHMENTS PRIOR TO USE, AND PERIODICALLY INSPECTING THE PRODUCTS FOR ADJUSTMENT, WEAR, AND DAMAGE. THEREFORE, YOU MUST READ AND UNDERSTAND ALL OF THE INSTRUCTIONS AND CAUTIONS SUPPLIED WITH YOUR PRORACK PRODUCT PRIOR TO INSTALLATION OR USE. IF YOU DO NOT UNDERSTAND ALL OF THE INSTRUCTIONS AND CAUTIONS, OR IF YOU HAVE NO MECHANICAL EXPERIENCE AND ARE NOT THOROUGHLY FAMILIAR WITH THE INSTALLATION PROCEDURES, YOU SHOULD HAVE THE PRODUCT INSTALLED BY A PROFESSIONAL INSTALLER SUCH AS A QUALIFIED GARAGE OR AUTO BODY SHOP.

## MAXIMUM LOAD LIMITS:



box weight

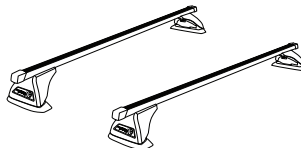

rack weight  
(if appropriate)

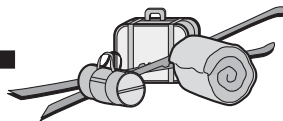

box contents



**DO NOT EXCEED  
YOUR RACK'S  
WEIGHT LIMIT!**

Check with your Prorack dealer or on the internet, go to [PRORACK.com](http://PRORACK.com), for your vehicle's load limits.

EXP4 ..... 35 lbs. / 15 kg

# 1 CROSSBAR SPREAD

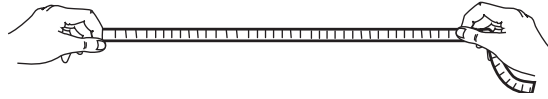

EXP4 .....24" - 36" (61 - 91 cm)



**BARS THAT MOVE:  
TIGHTEN YOUR CROSSBARS IF  
YOU LOOSENED THEM.**

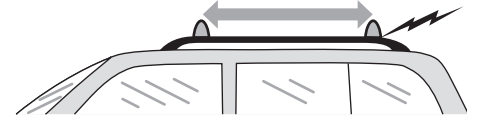

## 2

**OPEN THE BOX**  
(Use the key to  
unlock the box).

- TO OPEN THE BOX, unlock it.
- With the key still inserted, raise the lid.

*The key cannot be removed  
while the box is open.*

### INSIDE THE BOX:

**3** Loosen red knobs and open  
clamps. Do not remove knobs.

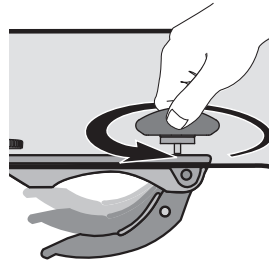

**4** Loosen track thumb wheels 1/2  
turn. *Do not remove wheels.*

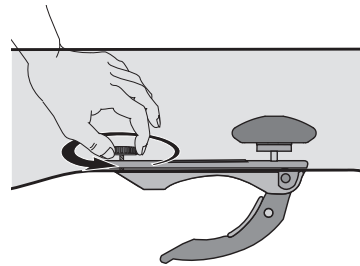

**REMOVING THUMBWHEELS  
WILL CAUSE DISASSEMBLY OF  
LEVER/CLAMP MECHANISM.**

### LOAD CARGO BOX ONTO VEHICLE:

## 5



Place box on vehicle with  
clamps in front of crossbars.  
*A friend could help with this.*

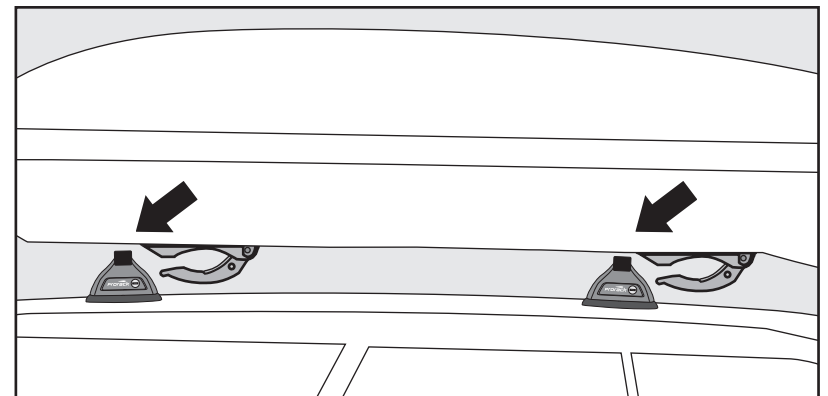

**6 OPEN LID TO GAIN ACCESS TO KNOBS.**

Slide clamps along tracks  
(inside box) to engage crossbars.

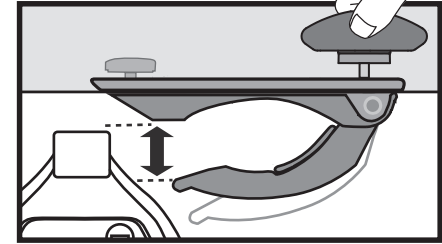
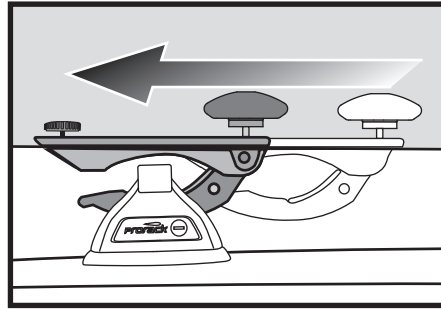
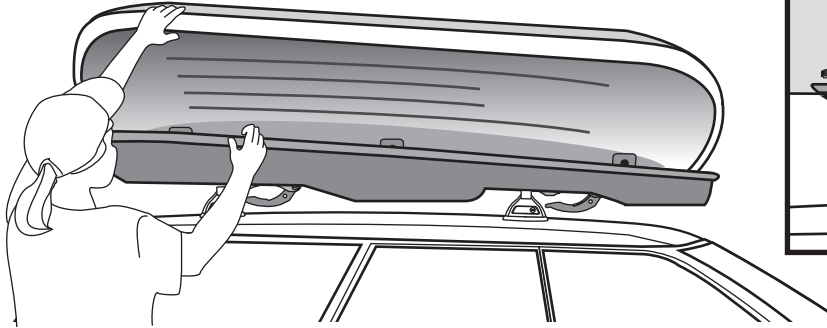

- Check clamp opening for crossbar clearance.
- Loosen red knob further if necessary.

**7 Adjust box on top of car.  
Measure from legs for reference.**

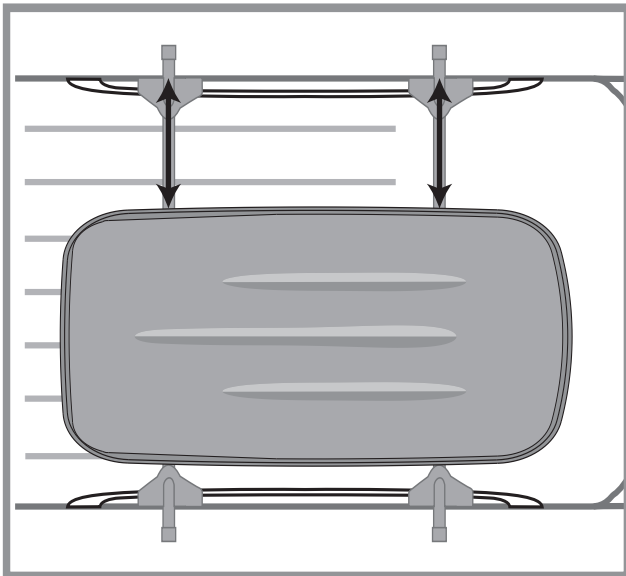

**IF POSSIBLE, POSITION BOX TO  
AVOID INTERFERENCE WITH BACK  
HATCH AND/OR SUNROOF.**

**8**

Tighten knobs to  
engage clamps.

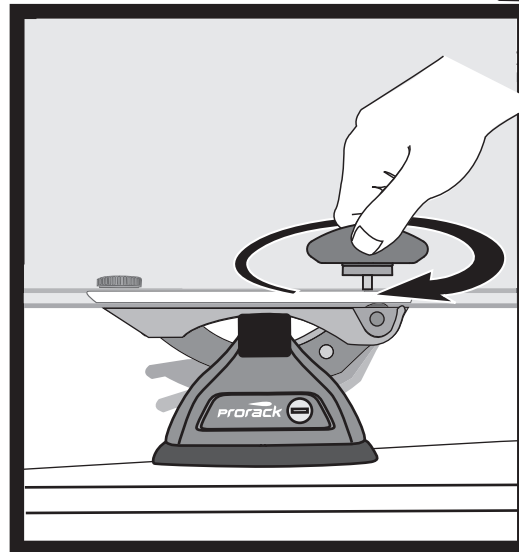

**9**

**TIGHTEN ALL  
THUMB WHEELS.**

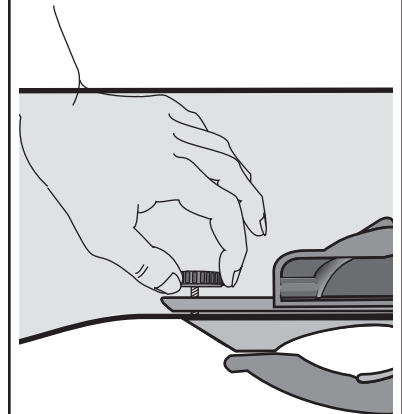

**10**

**CLOSE THE BOX:**  
Pull the lid down.



**11 LOCK THE BOX FOR A SECURE CLOSURE!**

- Overstuffing the box will prevent closure.
- Check the closure by pushing up on the lid.
- To lock the box, turn key all the way to the right until horizontal. Remove key.

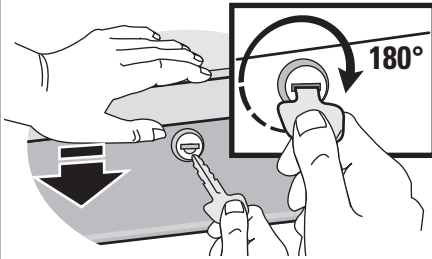

*TO OPEN THE BOX, unlock it. With the key still inserted, raise the lid. The key cannot be removed while the box is open.*

**UNLOCK / OPEN**

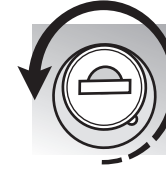

**LOCK**

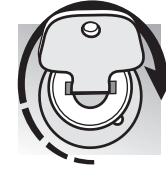

**NOT LOCKED!**



**12 CHECK INSTALLATION BEFORE DRIVING AWAY**

**Make sure installation is secure by tugging at box.**

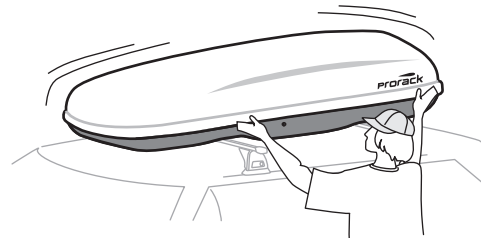

- The box should not slide on the bars.
- Open the box and tighten red knobs if necessary.

**TO REMOVE CARGO BOX:**

- Do not remove or adjust thumb wheels.
- Simply loosen red knobs and remove box from crossbars.

**TO REINSTALL:**

- With gear box adjusted to your vehicle, simply reload onto car, tighten red knobs and check for tightness.

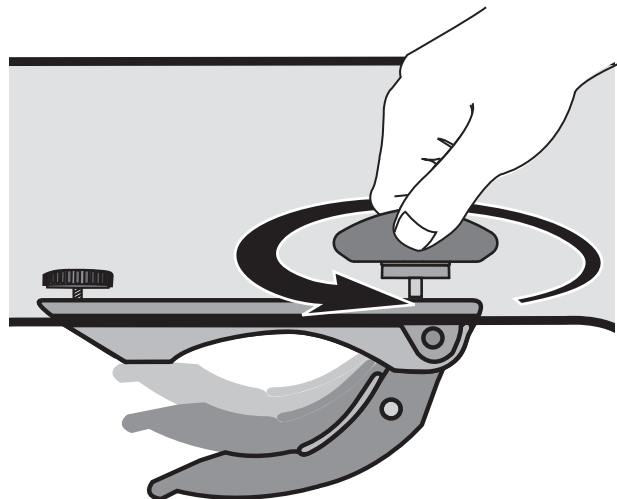

*To retain the adjustments for your vehicle, leave thumb wheels tightened.*  
**REMOVING THUMBWHEELS WILL CAUSE DISASSEMBLY OF LEVER/CLAMP MECHANISM.**

## CARE AND MAINTENANCE

### BOX CARE:

Use a clean soft cloth. Wash with mild soap and water. Polish with automotive type wax and UV protectant to prevent color fade.

### LOCK MAINTENANCE:

Spray a small amount of lubricant into lock mechanism once a month.

### AUTOMATIC CAR WASHES:

Do not enter car wash with box installed on vehicle.

---

**KEEP YOUR SECOND KEY IN A SAFE PLACE!**

## CAUTION

### IF YOUR VEHICLE HAS A REAR HATCH:

On some vehicles, hatch interference is unavoidable.

Use caution when opening your hatch.

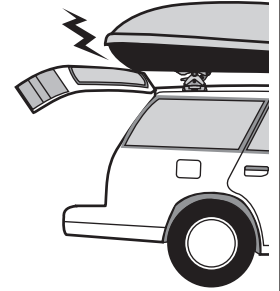

## READ THESE WARNINGS!

**Periodically check the knobs inside the box and tighten if necessary.**

**ATTACHMENT HARDWARE CAN LOOSEN OVER TIME. CHECK AND TIGHTEN IF NECESSARY, BEFORE EACH USE.**

**BE SURE ALL HARDWARE IS SECURED ACCORDING TO INSTRUCTIONS. FAILURE TO PERFORM SAFETY CHECKS BEFORE DRIVING AWAY CAN RESULT IN PROPERTY DAMAGE, PERSONAL INJURY, OR DEATH.**

---

**KEEP THESE INSTRUCTIONS IN A SAFE PLACE**

---